



PRODUCTS ARE PATENTED DOMESTICALLY AND INTERNATIONALLY.

THERE IS NO LIMIT IN THE PRODUCT RANGE.

While the parts are offered as products, it also offers you the modules that make up the products or the parts that make up the modules so that you can create hundreds of products limited by your imagination. You can make models, shelves, shelves, bookcases, cabinets, accessories or animal houses.

When the technique is understood, there is no need for a hand tool during assembly. When you are done with the product you are using, you can turn it into another product or fold it and put it away.

In fact, it is not a legendary product, it is a system of parts that make up the product. Since it has a design that is against the rules of geometry, it is far beyond the JIGSAW system. Every main part that makes up the module can change direction, all of them can change place, including the base where the pet steps.

ASSEMBLY AND DIFFERENCES:

MODULES 10-20-30-40-50-60 ARE SAME IN ASSEMBLY ORDER AND SHAPE.

AS THE MODULE GROWS, THE NUMBER OF MIDDLE FEET AND CLIPS INCREASES.

EKO 50 IS OPTIONAL, EKO 60 BUKELEMUN 50 AND 60 THERE IS ALUMINUM PROFILE SUPPORT UNDER THE STANDARD PERCH AND UNDER THE MODULE TOP PLASTIC.

IT CAN ALSO BE USED AS AN UNDER-ROOF CUPBOARD IN SIZES BETWEEN 30-60

THE ROOF OF 10-20-30 IS DIFFERENT AND EASY TO ASSEMBLY.

THERE IS NO PAN IN 10 AND 20.



LGN40_QUAIL CAGE

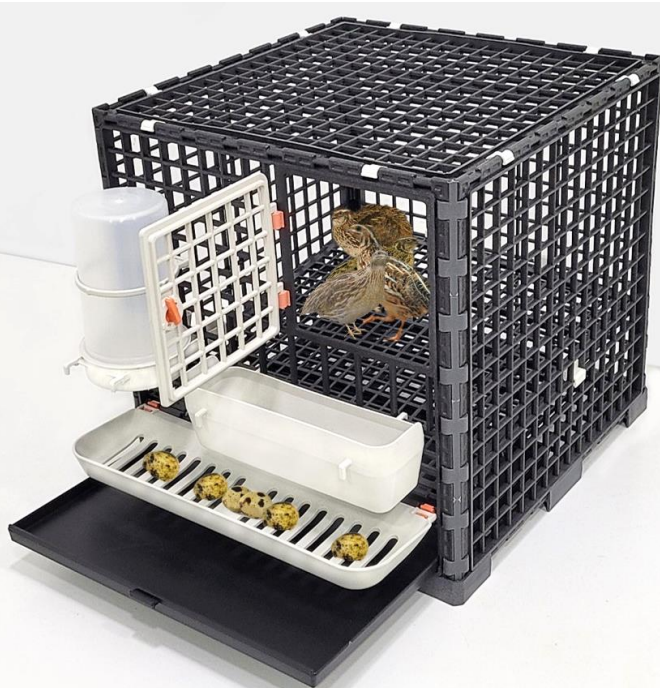

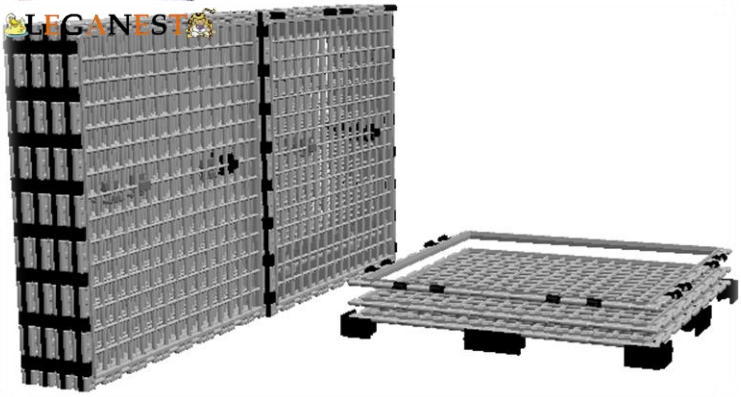

Open the folded module
with the bottom side up

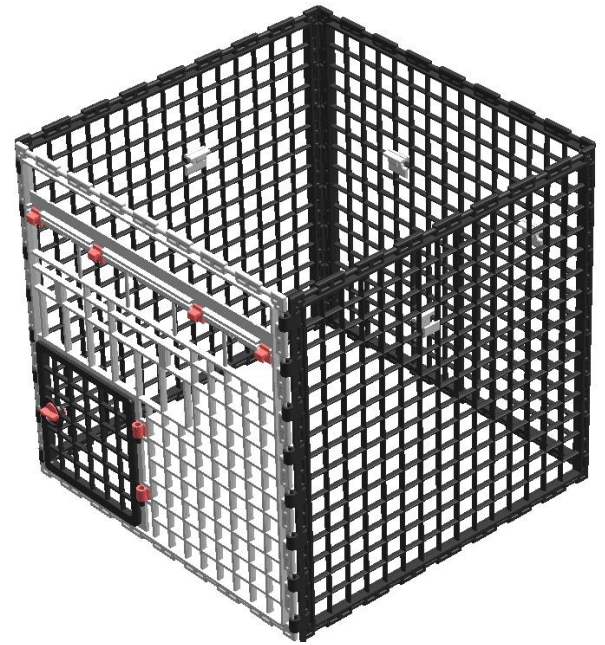

Press the hinges together

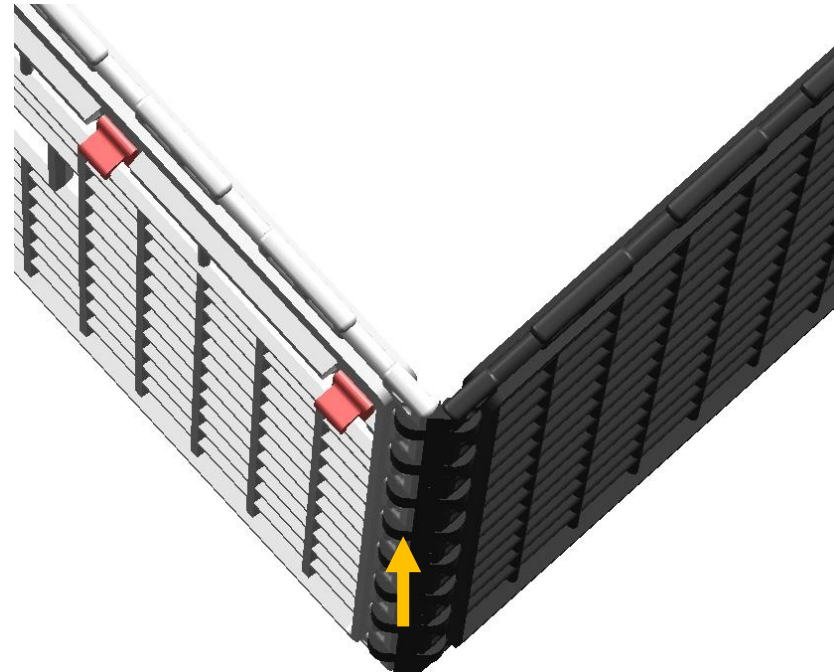
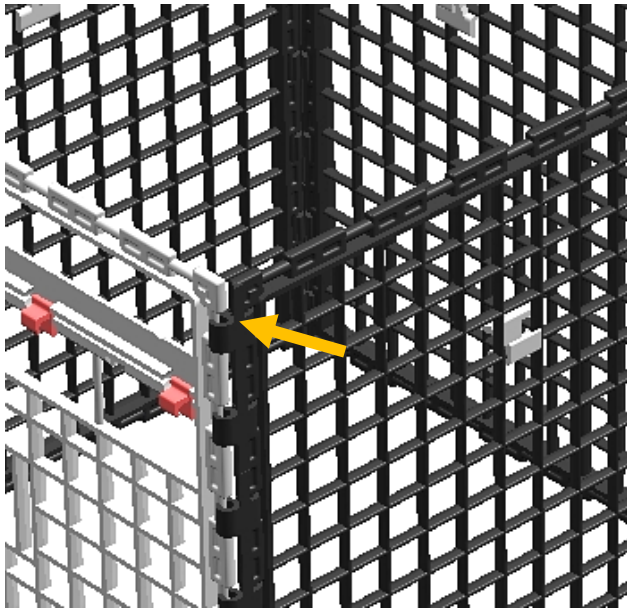

**Make sure the corners are
45 degrees**

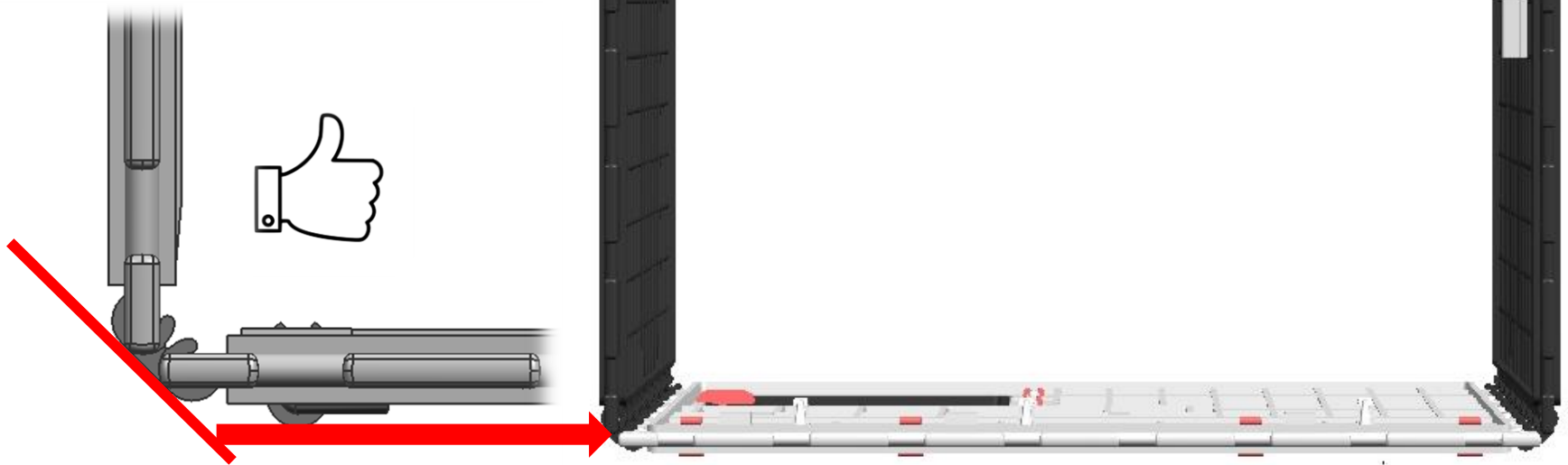



Place the wide spaced piece with nothing on it on the bottom

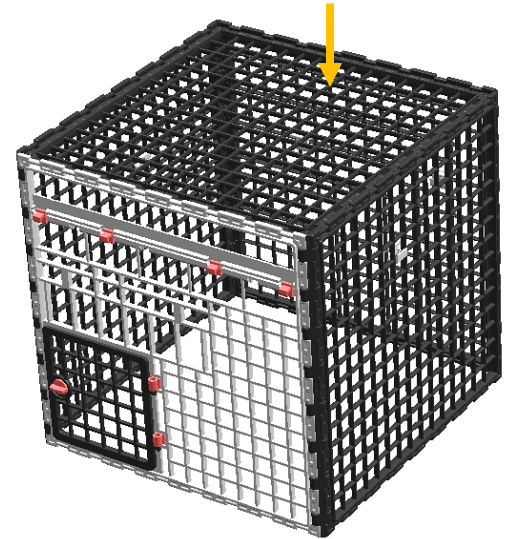
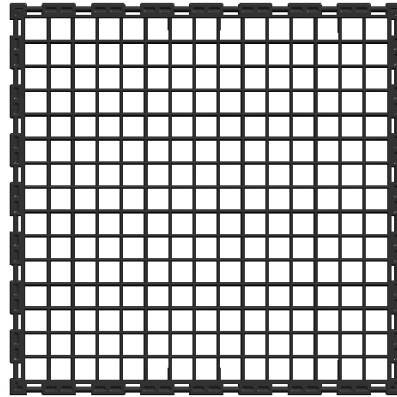
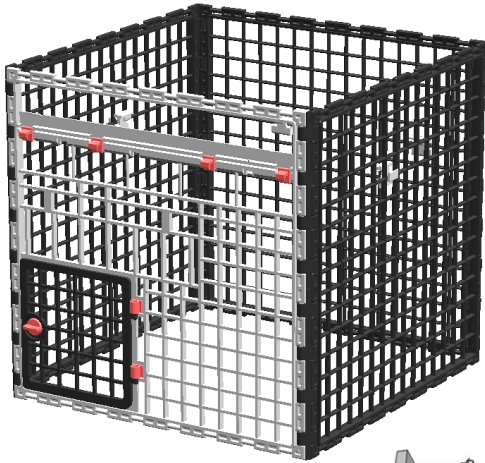

There are double clips on the side to be locked.

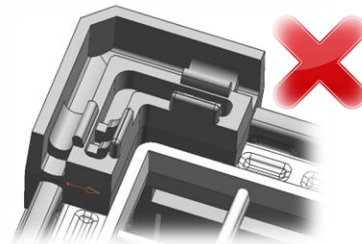
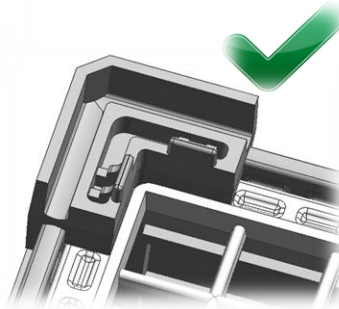
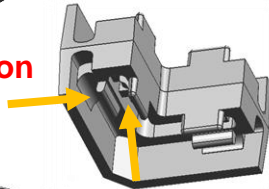

For easy assembly, lock one side and then the other side in 2 moves using the scissor technique.

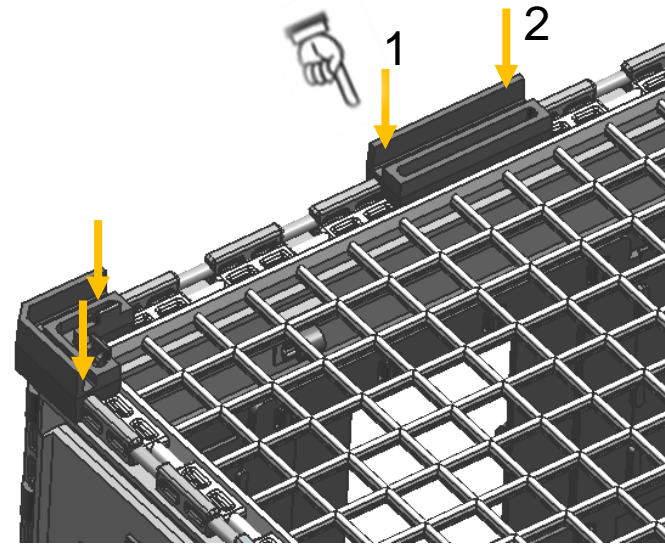



**TURN THE CAGE INTO
THE USE POSITION**



**Place the perch inside at an
angle, with the deep
protruding part facing down.**

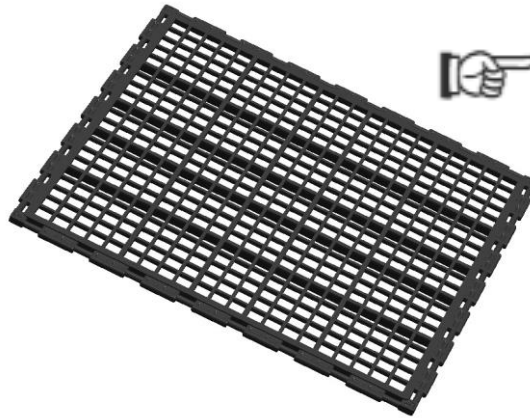

**Make sure it is on the clips and press until
you hear a click.**

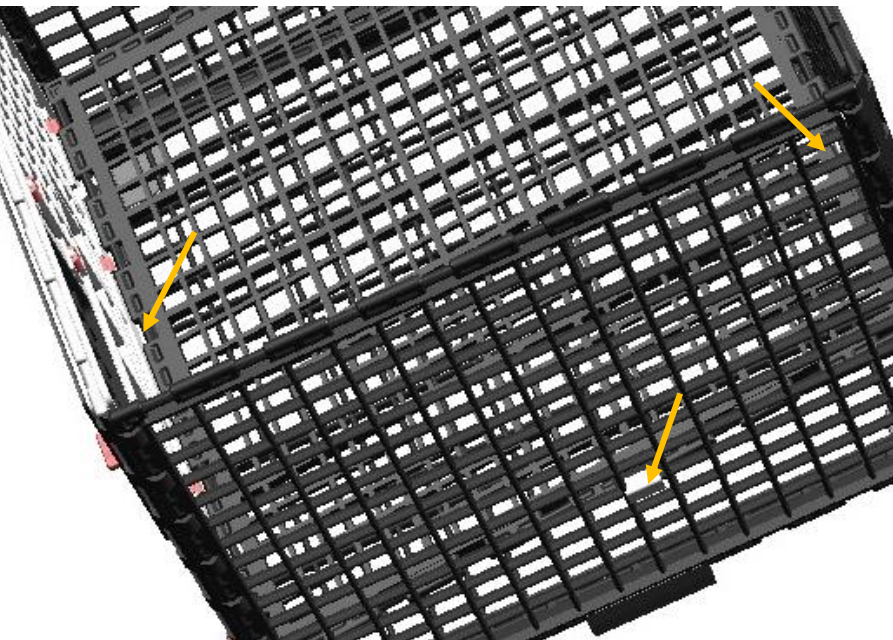



Attach the Piece with the White Clips to the Top.



Press down low torque clips



Place the Fertilizer Pan.

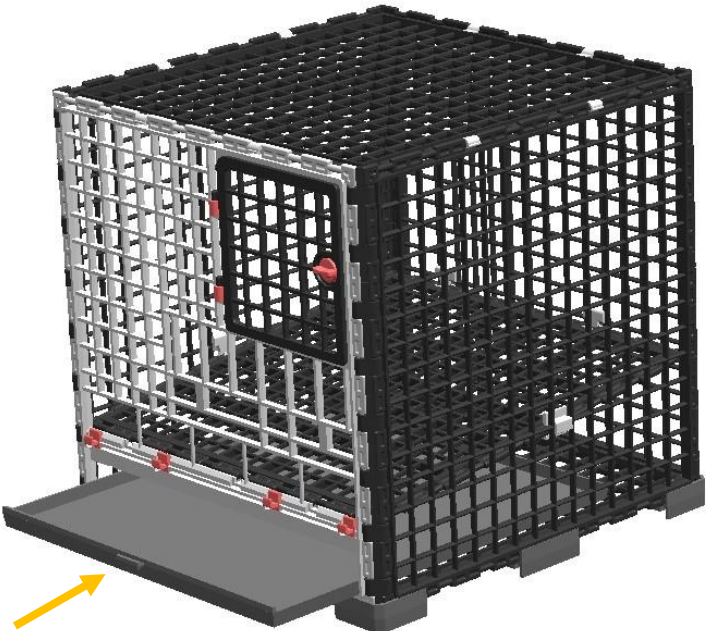

Attach the Egg Collector to its Clips.

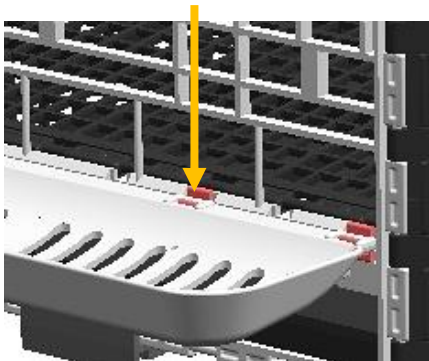

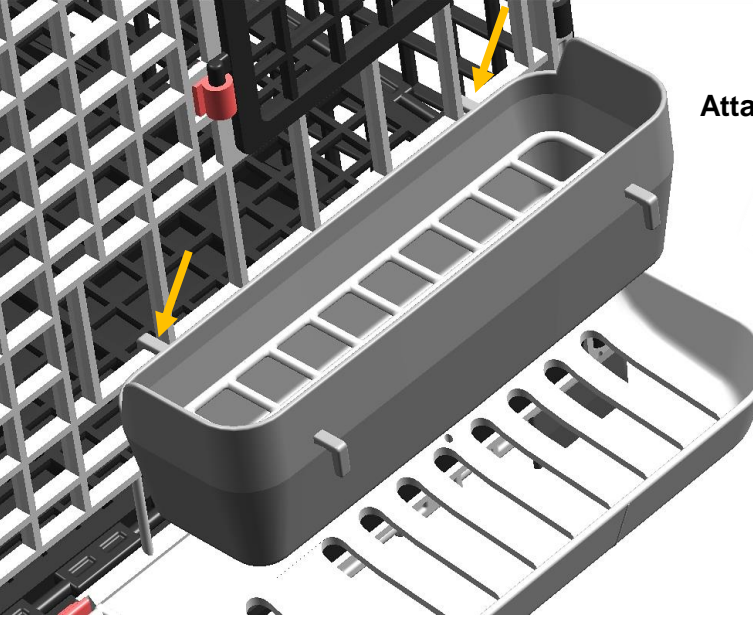

Attach the feeder by pressing it.

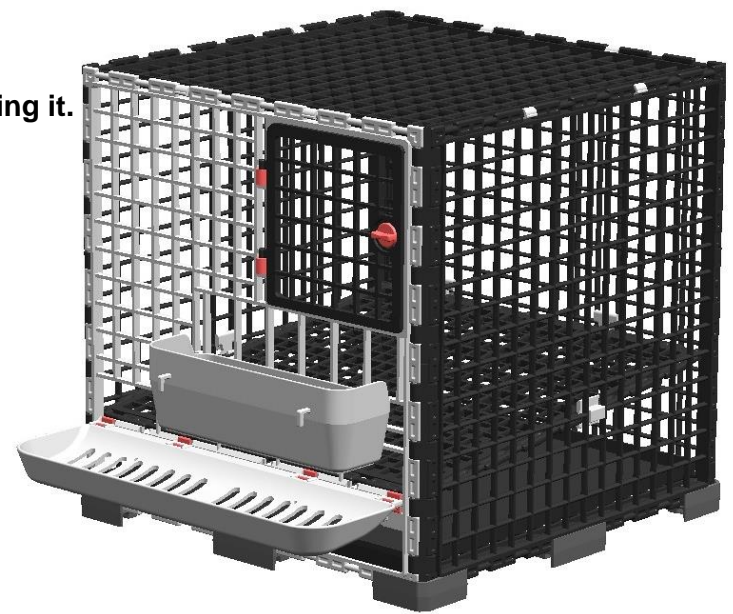

You can place the 1 lt water bottle on the sides and front at any height you want.

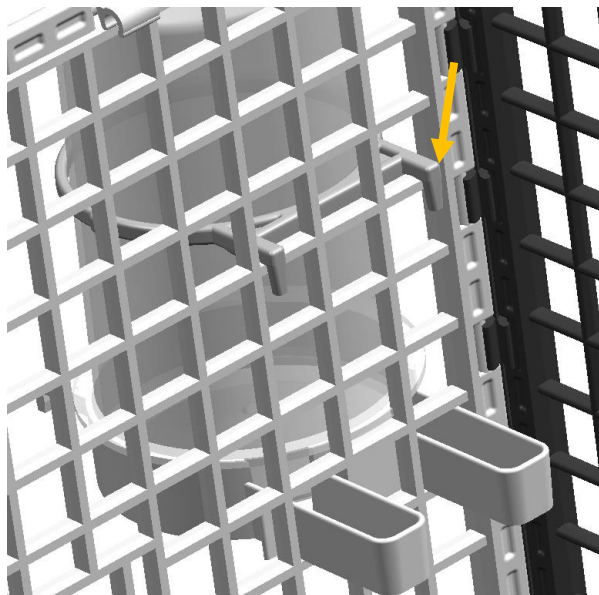



DISASSEMBLY AND ASSEMBLY TECHNIQUES EXAMPLES



HINGE

IT IS USED FOR JOINING AND FOLDING PURPOSES AT THE CORNERS OF THE MODULES. IT CAN BE REMOVED AND MOUNTED.

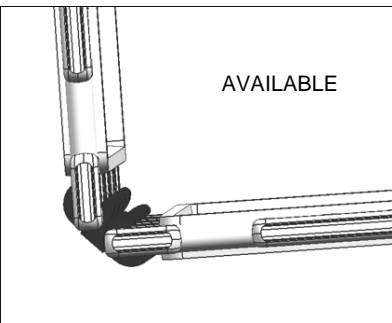

RETURN THE
CURRENT
POSITION TO
SHAPE 2

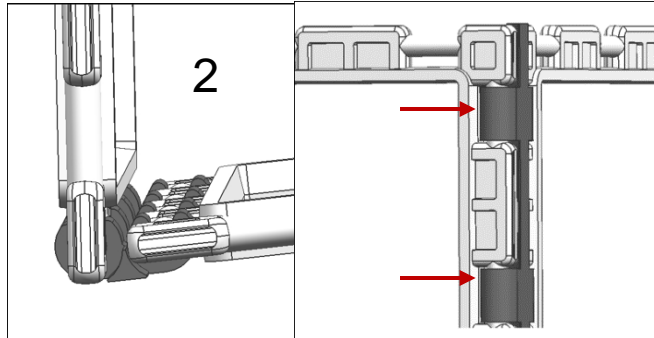

OPEN THE VACANT PART

OR



PUSH THE FRAMES IN DIFFERENT
DIRECTIONS AT THE SAME TIME

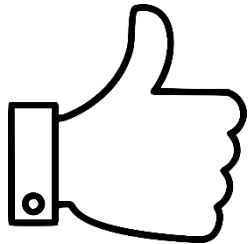
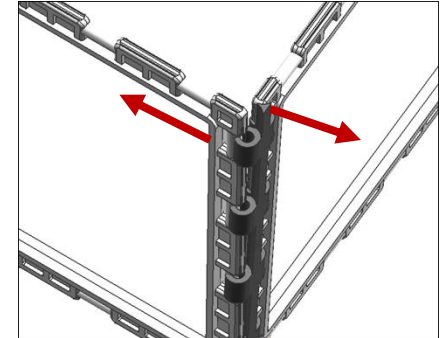

COMPLETE DISMANTLING

PUSH

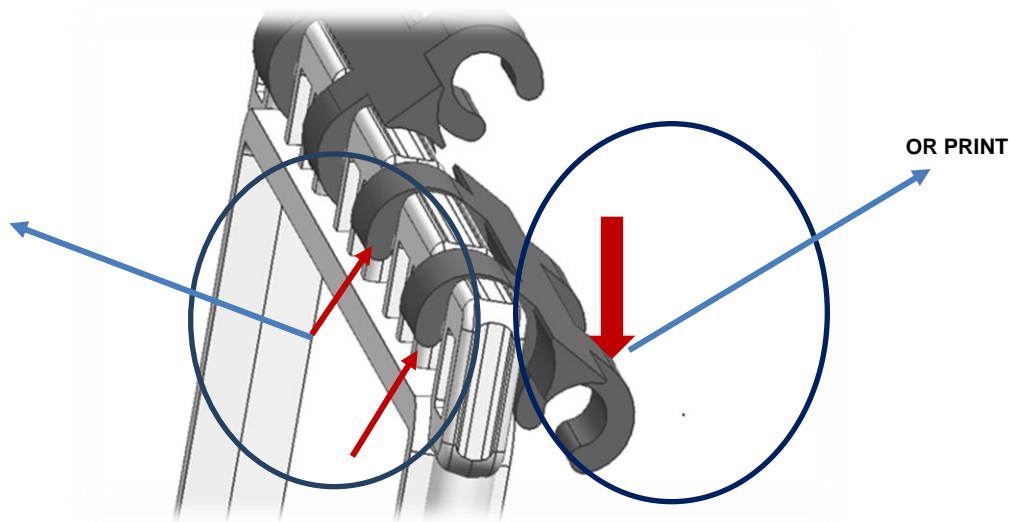

OR PRINT

THE PRODUCTS COMES ASSEMBLED. THIS IS INFORMATION FOR YOU TO DISASSEMBLY AND REASSEMBLY.

Base Pls or Grille Mounting Clip

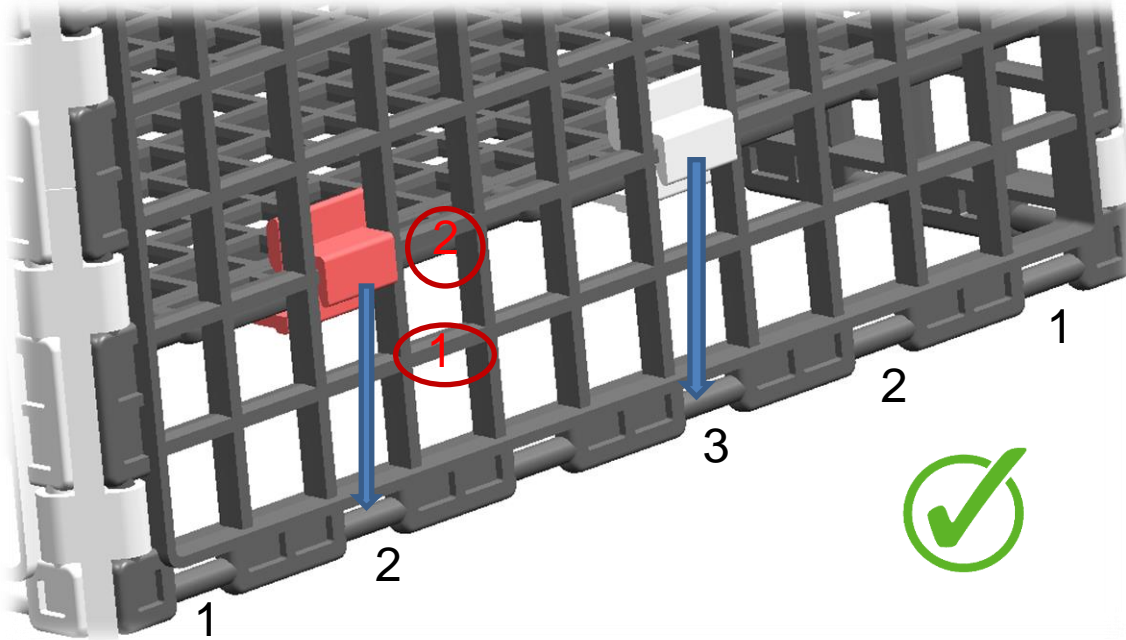
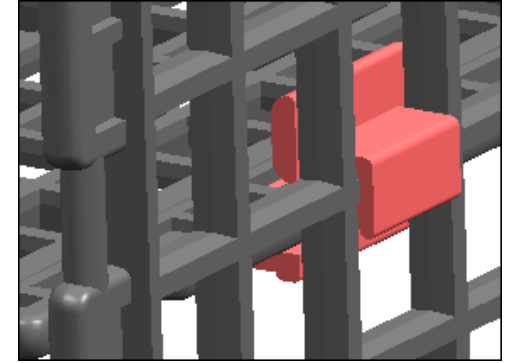
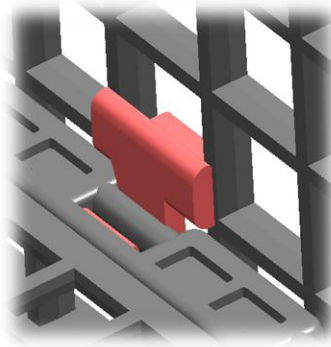
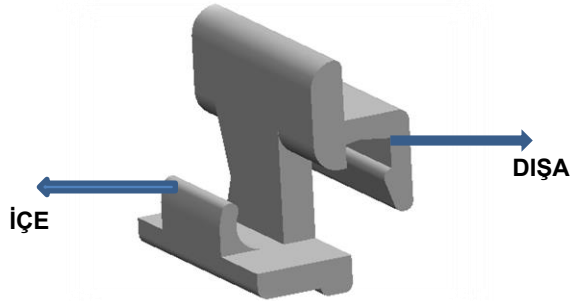

The clips must be at the 2nd rib (weft) from the bottom and the hinge assembly circular (diameter) level.

If you need to fold and lift the cage you made, attach it to the 2nd from the left and the 3rd from the right. If there is no need to fold, attach it at the desired distance

In case of incorrect assembly, turn it and pull it up to remove it. If the torque is high, use a pair of pliers or pincers.

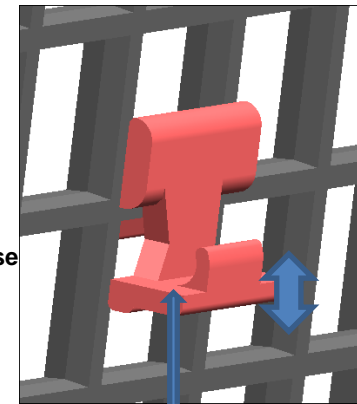
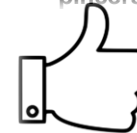

Hand tool holding part.

TOP COVER CLIP

It is not mandatory to use. It ensures that the top cover does not come off easily and the top of the module remains rigid. It fits tightly to the top cover. The top cover that will lock to the module is separated from the module with a slight torque for easy removal.

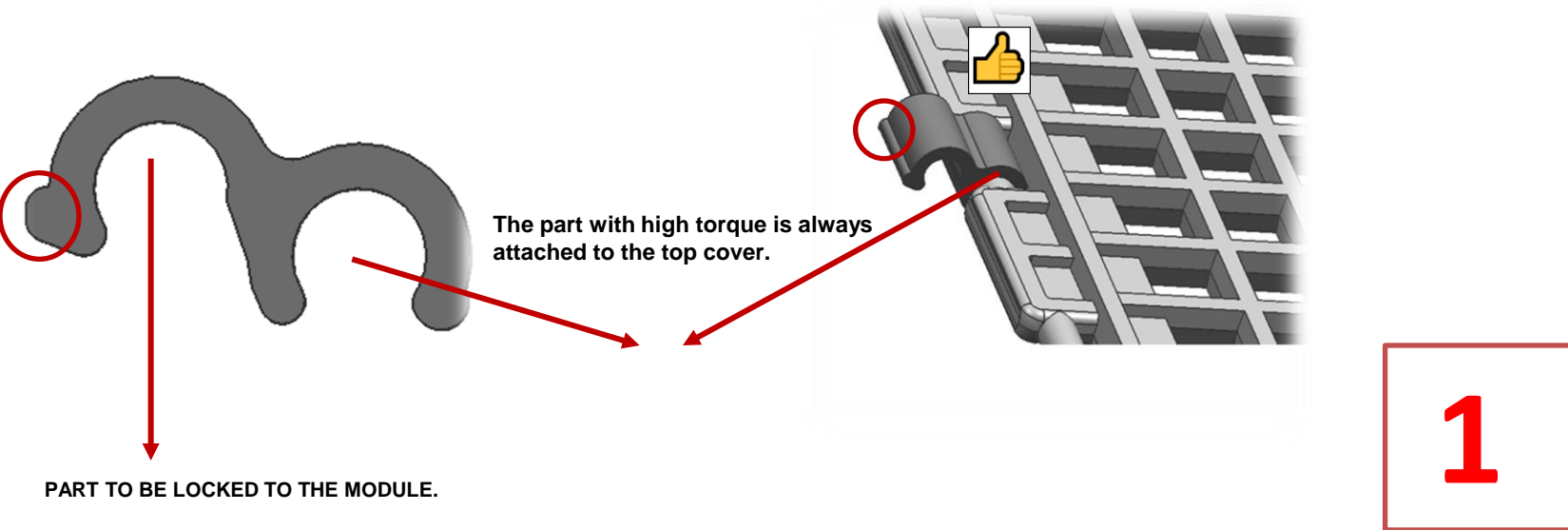

TOP COVER CLIP AND MODULE JOINING CLIP EASY REMOVAL TECHNIQUE

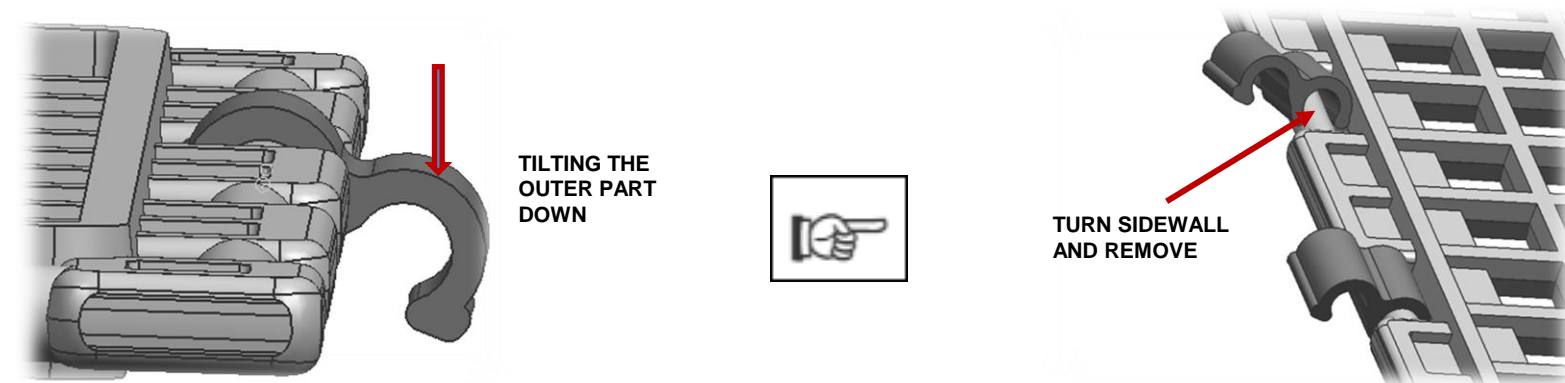

2

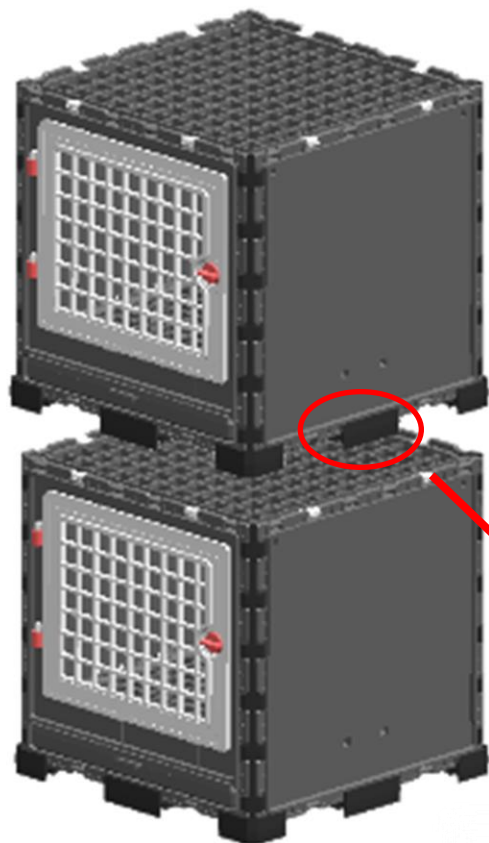

Make sure that the clips are not aligned with the feet when placing modules on top of each other.

